

Clamp pipe connection DIN 32676, flange Ø 25							Art.No	EUR	Art.No	EUR
Clamp gasket ASME 	DN	A	B				PTFE		PTFE-USP VI	
	1/4"	21,7	4,57				225498	5,00	226098	Enquiry
	3/8"	21,7	7,75				225499	5,00	226099	Enquiry
	1/2"	21,7	9,4				225401	5,00	226001	Enquiry
	3/4"	21,7	15,75				225402	5,00	226002	Enquiry
Clamp gasket ASME 	DN	A	B				VMQ		VMQ USP VI	
	1/4"	21,7	4,8 *				225898	2,80	224098	Enquiry
	3/8"	21,7	8,0 *				225899	2,80	224099	Enquiry
	1/2"	21,7	9,6 *				225801	2,80	224001	Enquiry
	3/4"	21,7	16 *				225802	2,80	224002	Enquiry
* The inner diameter B is a minimum dimension according industrial standard.										
Clamp gasket ISO 	DN	A	B				EPDM		EPDM USP VI	
	10,2	21,7	7,2 *				221415	2,30	223815	Enquiry
	13,5	21,7	10,5 *				221416	2,30	223816	Enquiry
	17,2	21,7	14,2 *				221417	2,30	223817	Enquiry
* The inner diameter B is a minimum dimension according industrial standard.										
Clamp gasket ISO 	DN	A	B				FKM		FKM USP VI	
	10,2	21,7	7,2 *				221615	3,60	224415	Enquiry
	13,5	21,7	10,5 *				221616	3,60	224416	Enquiry
	17,2	21,7	14,2 *				221617	3,60	224417	Enquiry
* The inner diameter B is a minimum dimension according industrial standard.										

Clamp pipe connection DIN 32676, flange Ø 25						Art.No	EUR	Art.No	EUR
Clamp gasket ISO	DN	A	B			PTFE		PTFE USP VI	
	10,2	21,7	7			221715	5,00	224715	Enquiry
	13,5	21,7	10,3			221716	5,00	224716	Enquiry
	17,2	21,7	14			221717	5,00	224717	Enquiry

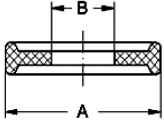

Clamp gasket ISO	DN	A	B			VMQ		VMQ USP VI	
	10,2	21,7	7,2 *			221515	2,80	224115	Enquiry
	13,5	21,7	10,5 *			221516	2,80	224116	Enquiry
	17,2	21,7	14,2 *			221517	2,80	224117	Enquiry

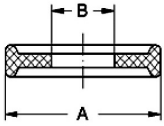
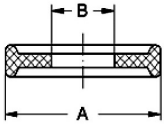
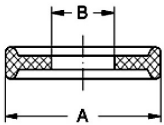
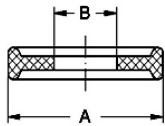
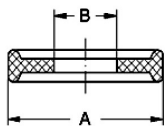

* The inner diameter B is a minimum dimension according industrial standard.

Clamp gasket DIN, enveloped	DN	A	B			PTFE-FKM		PTFE-FKM USP VI	
	6	21,7	6			221828	9,80	224828	Enquiry
	8	21,7	8			221829	9,80	224829	Enquiry

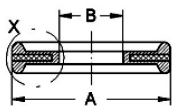

Detail X

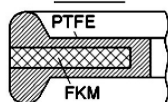

Clamp gasket ASME, enveloped	DN	A	B			PTFE-FKM		PTFE-FKM USP VI	
	1/4"	21,7	4,57			225598	9,80	226198	Enquiry
	3/8"	21,7	7,75			225599	9,80	226199	Enquiry
	1/2"	21,7	9,4			225501	9,80	226101	Enquiry
	3/4"	21,7	15,75			225502	9,80	226102	Enquiry

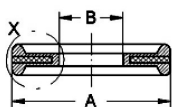

Detail X

